

AUTHENTIC LUXURY

La Datcha

FORTE DEI MARMI

PALAZZO EST. 1930

---

# LA DATCHA YACHT PERSHING 9X

[y.bohutsky@ladatcha.com](mailto:y.bohutsky@ladatcha.com)

+39 342 681 00 11



Go on a beautiful trip along the Tyrrhenian coastline.

In addition to the Palazzo and your own private beach, you can book La Datcha Yacht — an elegant brand new Pershing 9X.

3 crew members, accommodation is for 12 day guests or maximum 8 overnight guests accommodated in four cabins including a full-beam master cabin complete with walk-in wardrobe, along with two twin cabins and a VIP in the bow.

The yacht's crew will help choose the best route for your sea trip.



## Destinazioni

- PORTOVENERE
- CINQUE TERRE
- PORTOFINO
- ISOLA D'ELBA

Departure from Viareggio or from our Datcha beach upon good weather and sea conditions.

Pershing 9X price:

EUR 9,900 per day for Palazzo La Datcha guests.

The fee includes a complimentary fresh fruit basket and a Magnum bottle of Moët champagne and does not include VAT, additional food&drinks, fuel and port charges.

# PORTOVENERE

1 Day



Departure from Viareggio to Portovenere (travel time to arrive about 45 minutes).

Discovering the beautiful Gulf of Poets, with amazing view of Lerici medieval castle, just a few minutes far from Eco del Mare, Tellaro and Fiascherino bay where you will swim in a crystal blue sea. Lunch at restaurant (into Portovenere Port or on Palmaria Island) rest of the day on board at the anchor into a bay of La Spezia gulf, view ancient church of Portovenere, Possibility to use Seabob, water ski, water toys, jet ski etc.





# PORTOVENERE

Recommended Boarding time is 9:00am from Viareggio Port (LU) few kilometres from La Datcha Forte dei Marmi or 9:30am from La Datcha Beach sea conditions permitting.

Max. Guests accepted on Board 12 (twelve) children included.

In case of bad weather and sea conditions the cruise will not take place (changes in dates can still be made, compatibly with other bookings).

N.B: the Captain have the authority to exclude any or all Guests from use of any particular water sports equipment if they are not in possession of the appropriate necessary licenses.



# CINQUE TERRE NATURAL PARK (VERNAZZA)

1 Day



Departure from Viareggio to Vernazza a remote hardscrabble fishing village into Cinque Terre National Park, UNESCO site from 1997 (travel time about 1 hour and 30 minutes.) Lunch at restaurant into an ancient Saracen tower suspended on an intriguing stately cliff with a unique panoramic view.



# CINQUE TERRE NATURAL PARK (VERNAZZA)

Rest of the day on board at the anchor into wonderful Golfo dei Poeti (Gulf of Poets). Possibility to use Seabob, water ski, water toys, jet ski etc.

Recommended Boarding time is 9:00am from Viareggio Port (LU) few kilometres from La Datcha Forte dei Marmi or 9:30am from La Datcha Beach sea conditions permitting.

Max. Guests accepted on Board 12 (twelve) children included.

In case of bad weather and sea conditions the cruise will not take place (changes in dates can still be made, compatibly with other bookings).

N.B: the Captain have the authority to exclude any or all Guests from use of any particular water sports equipment if they are not in possession of the appropriate necessary licenses.





# PORTOFINO

1 Day



Departure from Viareggio to PORTOFINO  
(travel time about 2 hours.)

Portofino is a small fishing village on the Ligurian coast located south-east of Genoa. Pastel-colored houses, exclusive boutiques and restaurants with fish specialties overlook the cobbled Piazzetta overlooking the harbor. A trail connects the Piazzetta to the Brown Castle, a sixteenth-century fortress that offers views of the town and the Ligurian Sea.





# PORTOFINO

Lunch in one of the famous fish restaurant in the main Piazzetta. Rest of the day on board with possibility to use Seabob, water ski, water toys, jet ski etc.

Recommended Boarding time is 9:00am from Viareggio Port (LU) few kilometres from La Datcha Forte dei Marmi or 9:30am from La Datcha Beach sea conditions permitting.

Max. Guests accepted on Board 12 (twelve) children included.

In case of bad weather and sea conditions the cruise will not take place (changes in dates can still be made, compatibly with other bookings).

N.B: the Captain have the authority to exclude any or all Guests from use of any particular water sports equipment if they are not in possession of the appropriate necessary licenses.



# ISOLA D'ELBA

1/2 Day



Daily or 2 days charter (overnight 8 guests in 4 cabins; 12 maximum guests on daily use). Departure from Viareggio to Isola d'Elba (travel time about 2,30 hours.)

Elba is an island in the Tuscan Archipelago National Park renowned for its beaches and for hosting Napoleon Bonaparte during his exile (1814-15). In the northern town of Portoferraio, exhibits at the National Museum of Napoleonic Residences retrace the French emperor's stay.



# ISOLA D'ELBA

You can swim in the most beautiful bays of crystalline blue sea in Tuscany, discover wonderful inlets and beaches like La Biodola, Capoliveri, Cavoli, Fetovaia and Sant'Andrea.

In the afternoon you can enjoy visiting the small fishing port or spend your time shopping in the little and old town of Porto Azzurro.

You can enjoy an aperitif at one of the bar facing the suggestive tourist ports and then choose for a dinner onboard rocked by the waves or at a typical fish restaurants in this suggestive island.

Possibility to use Seabob, water ski, water toys, jet ski etc.

Recommended Boarding time is 9:00am from Viareggio Port (LU) few kilometres from La Datcha Forte dei Marmi or 9:30am from La Datcha Beach sea conditions permitting.

Max. Guests accepted on Board 12 (twelve) children included.

In case of bad weather and sea conditions the cruise will not take place. (changes in dates can still be made, compatibly with other bookings).

N.B: the Captain have the authority to exclude any or all Guests from use of any particular water sports equipment if they are not in possession of the appropriate necessary licenses.







BENVENUTO A BORDO  
WELCOME ON BOARD













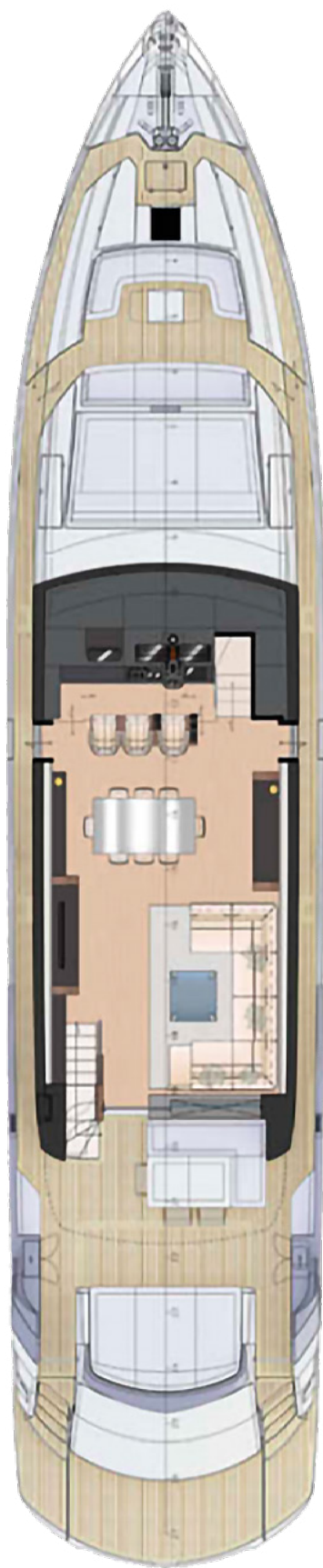

## MAIN STANDARD FEATURES

- 4 cabins, 4 heads, 1 day head
- Separated Crew Area with 2 cabins, 3 beds and 1 head
- Garage with tender Williams 3,85mt. + jet ski Seadoo Spark
- 2x20Kw genetarors
- Hideaway glass aft door
- Telescopic gangway
- Separate washer and dryer units
- Front external dinette
- Upper sun deck with sunpad + sitting area
- 2 electric side doors for external access
- Forniture timber: preformed acero frisè grey
- Watermker 130 lt/h
- Antenna TV SAT with decoders in all cabins





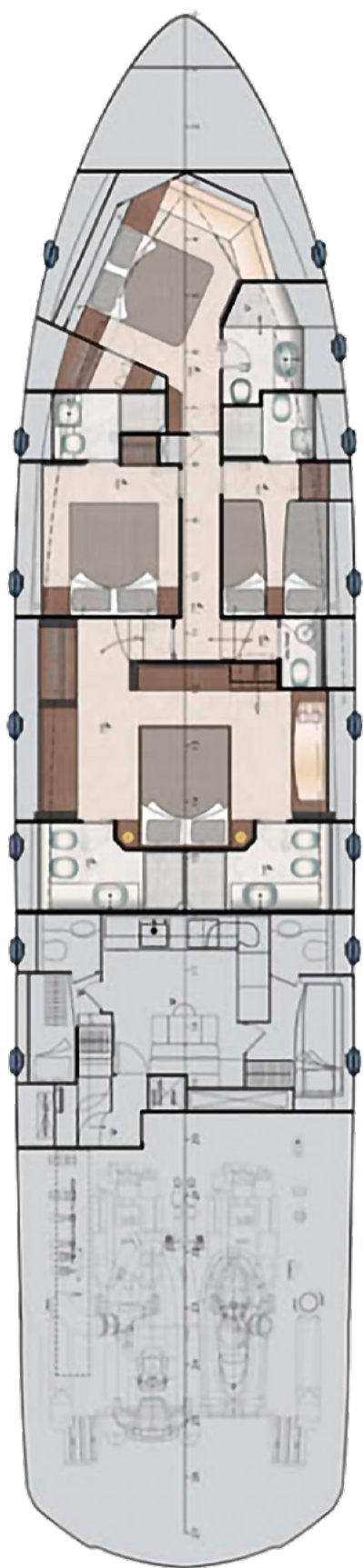

## Trasmission

Top System 105

## Depth under propellers

1,65 m (5 ft 5 in)

## Loa

(overall lenght)

28,14 m (92 ft 4 in)

## Lh (hull lenght)

23,91 m (78 ft 5 in)

## Maximum deam

6,23 m (20 ft 5 in)

## Displacement laden

79,4 ton

## Cruiser speed

38 kn

## Top speed

42 kn

## Range al cruiser speed

380 nm





## Contact us

+39 342 681 00 11

[y.bohutsky@ladatcha.com](mailto:y.bohutsky@ladatcha.com)

